



IMPORTANT: Read ALL instructions before starting installations.







CAUTION: To reduce risk of shock, **TURN OFF ELECTRICAL SUPPLY** before installing/servicing fixtures.

WARNING: Fixture must be installed in accordance of National Electrical Code (NEC) and /or any local codes.
Failure to do so may result in serious injury and/or damage to the fixture.

SAFETY INSTRUCTIONS

- **Verify that supply voltage matches the voltage marked on the fixture label. Failure to do so may result in damage to the light fixture and will void the warranty.**
- Observe and follow all label information and instructions regarding dry, damp and wet location listings, proper type and wattage, warnings of installation near combustible materials and or insulation.
- Be sure to connect ground wire to prevent electric shock or other potential hazards.
- Product must be installed in a manner consistent with the intended use and in compliance with national electrical codes and local codes.
- This product must be installed in accordance with the applicable installation code by a person familiar with the construction and operation of the product and the hazards involved.
- These instructions do not purport to cover all details or variations of installations, operation or maintenance. Contact Solais Lighting Group if a specific problem or clarification needs to be addressed that is not covered by these instructions.

RECOMMENDED TOOLS

Wire Nuts 	Wire Cutter/Stripper 	Hardware <ul style="list-style-type: none"> • ¼ - 20 hardware • #8 - 32 x ½" screws • ⅜ - 16 x 2" bolts 	Drill and Paper Hole Diagram 	Torx T-15 and #2 Phillips 	⅞" and ⅝" Ratchet/Socket 
---	--	--	--	---	--

WIRING DIAGRAM

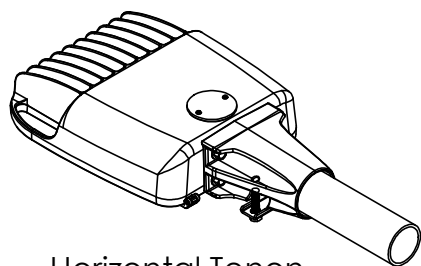
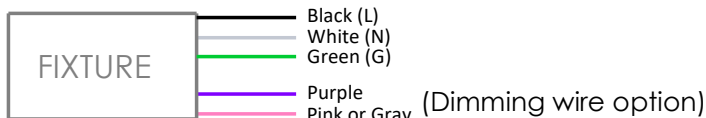

Horizontal Tenon

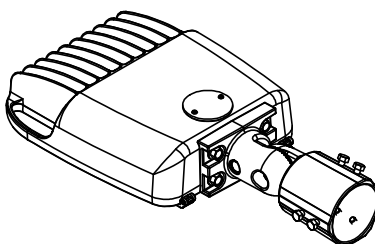

Knuckle Mount

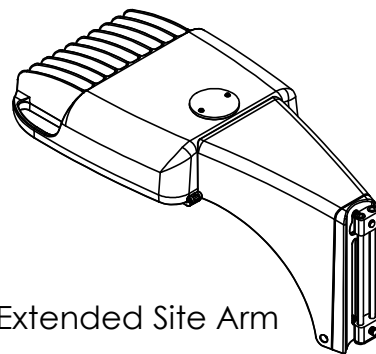

Extended Site Arm

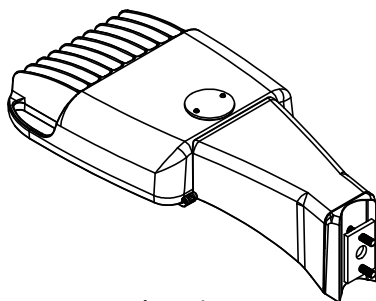

Fixed Arm

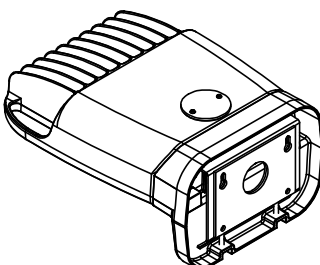

Wall Pack

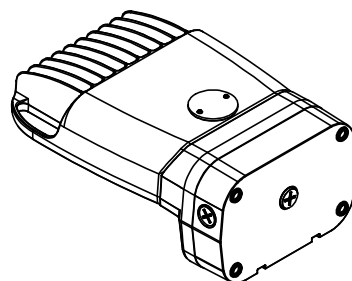

Wall Pack with SMCB

INSTRUCTIONS: HORIZONTAL TENON

- Horizontal tenon arm designed to accept a 2" schedule 40 pipe (2-3/8" OD) but able to secure to smaller outside diameter pipe (1-5/8" minimum).
- Loosen (2) 3/8-16 bolts provided at pipe clamp bracket in order to mount fixture with horizontal tenon arm over the pole tenon.
- Use wire nuts (not supplied) to connect fixture wires to supply wires and tuck inside pole/tenon.
 - Strain relief supply wires to prevent pull on wire connections.
- Slip fixture onto pole tenon until it stops against the internal vertical wall.
 - Be careful not to pinch wires.
- Ensure fixture is aimed down or in the desired position and tighten the (2) 3/8-16 bolts with 30-35 ft-lbs of torque. Tighten the two bolts evenly
- Turn on power.

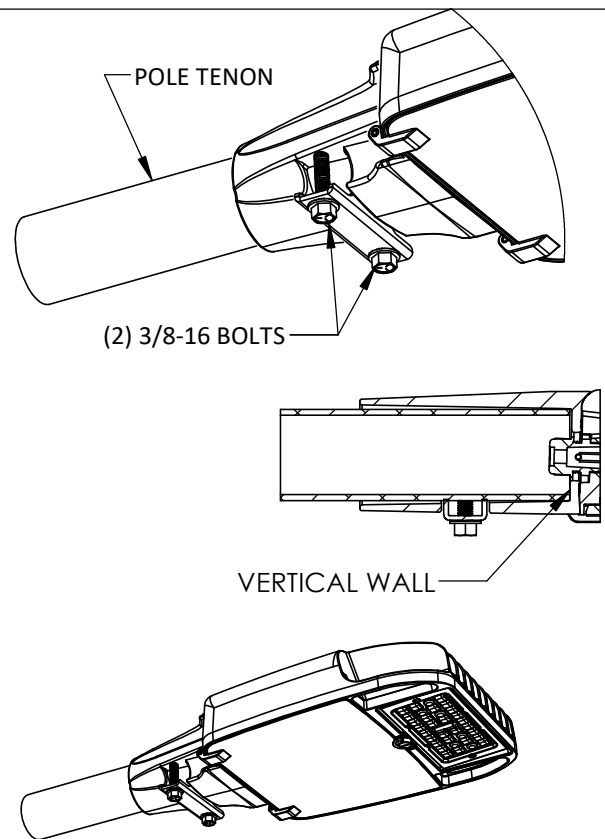

INSTRUCTIONS: KNUCKLE MOUNT

- Loosen all (6) 5/16-18 hex head bolts on the bottom adapter.
- Prior to installing fixture on the pole/tenon, use wire nuts (not supplied) to connect fixture wires to supply wires and tuck inside the pole/tenon.
 - Side cable exit is available with the removal of the cap. Extension cable can be ordered, pre-wired and routed through the side hole.
- Slip fixture onto the pole/tenon until it stops against internal wall of adapter.
 - Be careful not to pinch wires.
- Ensure fixture is aimed in the desired direction and then secure the (6) 5/16-18 bolts with 11-15 ft-lbs of torque.
- To adjust the angle of the fixture, loosen the 3/8-16 bolt enough to disengage the teeth of the adapters.
- Rotate the fixture housing to the desired angle and retighten the 3/8-16 bolt with 30-35 ft-lbs of torque.
 - Note angular adjustment marks on knuckle castings and set future fixtures at the same angle if desired.
- Turn on power.

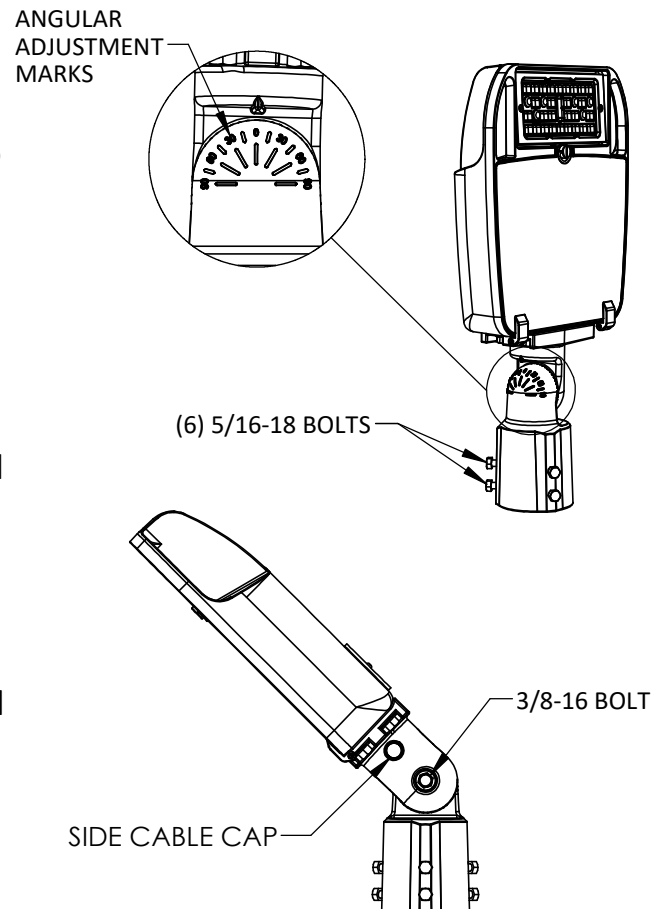

INSTRUCTIONS: EXTENDED SITE ARM

- Square pole and Round pole installation instructions are similar with differences listed below.
 - Note orientation of pole mount (PM) bracket.
 - Note additional ERP adapter for round pole.
- Use or reference full scale drill template if pole is not pre-drilled.
- Inside the pole, align the holes of the pole mount (PM) bracket with the drilled holes of the pole.
- Install a 3/8-16 bolt (provided) through the top hole in pole and thread into the pole mount (PM) bracket.
 - Don't tighten until after mounting fixture arm.
- Loosen (2) captive 10-24 screws in fixture arm and rotate open the access door.
- Mount ERP adapter (if applicable) and the fixture arm onto the bolt in pole using the top keyhole slot(s).
- Secure fixture using the other 3/8-16 bolt and torque both bolts to 30-35 ft-lbs.
- Use wire nuts (not supplied) to connect fixture wires to supply wires and tuck inside pole or inside access arm area.
- Strain relief supply wires to prevent pull on wire connections.
- Secure access door with original (2) captive 10-24 screws and torque to 28-32 in-lbs.
 - Careful not to pinch wires.
- Turn on power.

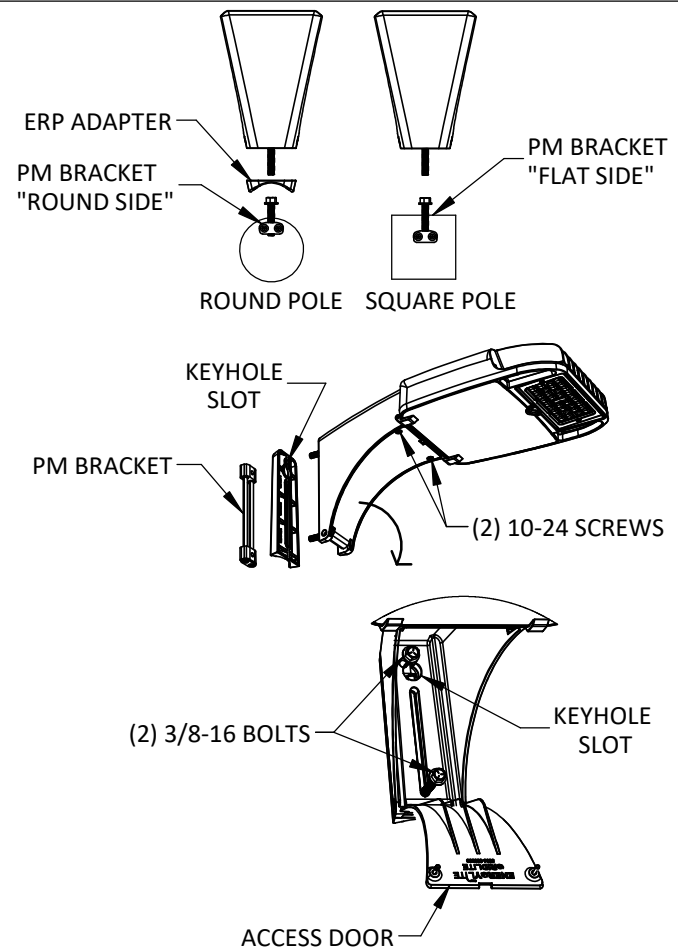

INSTRUCTIONS: FIXED ARM

- Square pole and Round pole installation instructions are similar except the additional FRP adapter for round pole.
- Use or reference full scale drill template if pole is not pre-drilled.
- Inside the pole, align the holes of the pole mount (PM) bracket with the drilled holes of the pole.
- Install mounting adapter with FRP adapter (if applicable) onto pole using (2) 3/8-16 long bolts (provided) and thread into the pole mount (PM) bracket.
 - Torque both bolts to 30-35 ft-lbs.
 - Orient top of adapter(s) as shown.
- Slide fixture over the mounting adapter so that the pre-installed brace plate catches behind the top ledge of mounting adapter.
 - Fixture arm must sit flush with pole or adapter.
- Secure fixture using the other (2) 3/8-16 short bolts (provided) and torque both bolts to 30-35 ft-lbs.
- Fixture wires are routed through arm under the wire cover and extend beyond arm.
 - Confirm wire cover is snapped into place.
- Use wire nuts (not supplied) to connect fixture wires to supply wires and tuck inside pole.
- Strain relief supply wires to prevent pull on wire connections.
- Turn on power.

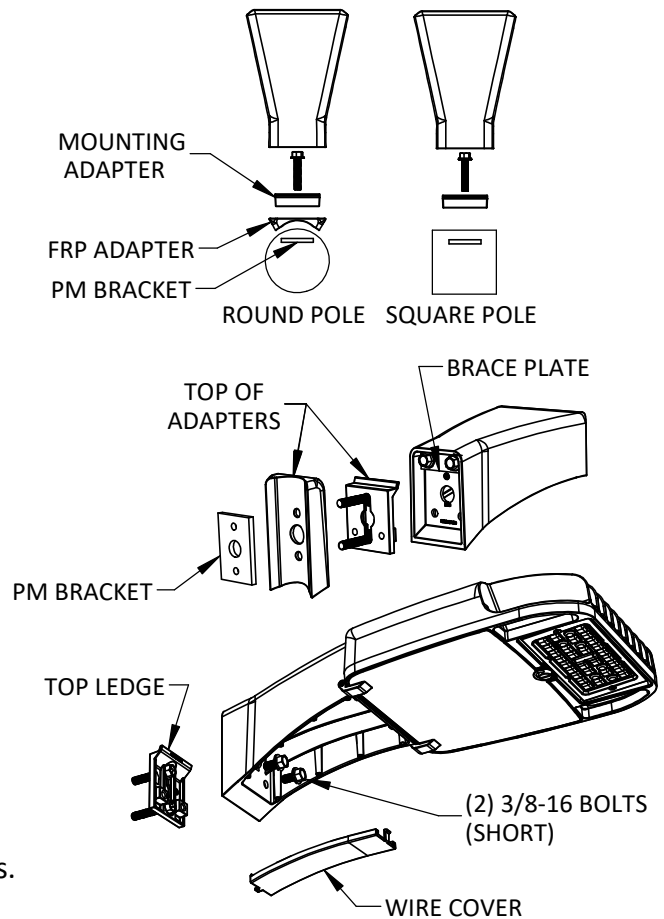

5017-000014, rev. A

INSTRUCTIONS: WALL PACK (GL1, GL2, GL3 Only)

- Use or reference template to mark and drill for (4) 1/4" hardware suited for mounting surface. Ensure template is level.
- Loosen the (2) 1/4-20 screws in order to remove wall bracket from fixture. Keep threads protruding through casting as shown.
- Feed supply wires from wall through center opening in wall bracket. Face gasket on bracket towards the wall.
- Secure wall bracket to the wall using (4) 1/4" hardware (not supplied). Tabs on bracket must be on top as shown.
- Position supply wires to the left or right of the bracket.
- Mount fixture by sliding it over the (3) tabs of the wall bracket. Brace plate inside the wall pack housing will catch behind tabs.
- - Carefully check engagement before proceeding.
- Allow the (2) 1/4-20 screws to rest on the wall bracket with the fixture slightly tilted away from the wall.
- Use wire nuts (not supplied) to connect fixture wires to supply wires and tuck inside wall pack housing.
- Now back out the (2) 1/4-20 screws until they clear the wall bracket and position fixture parallel to the wall.
- - Careful not to pinch wires.
- Fasten fixture to wall bracket with (2) 1/4-20 screws and torque to 15 in-lbs.
- Apply RTV or silicone to seal along top and side edges of wall pack housing and the wall. Do NOT seal along bottom edge.
- Turn on power.

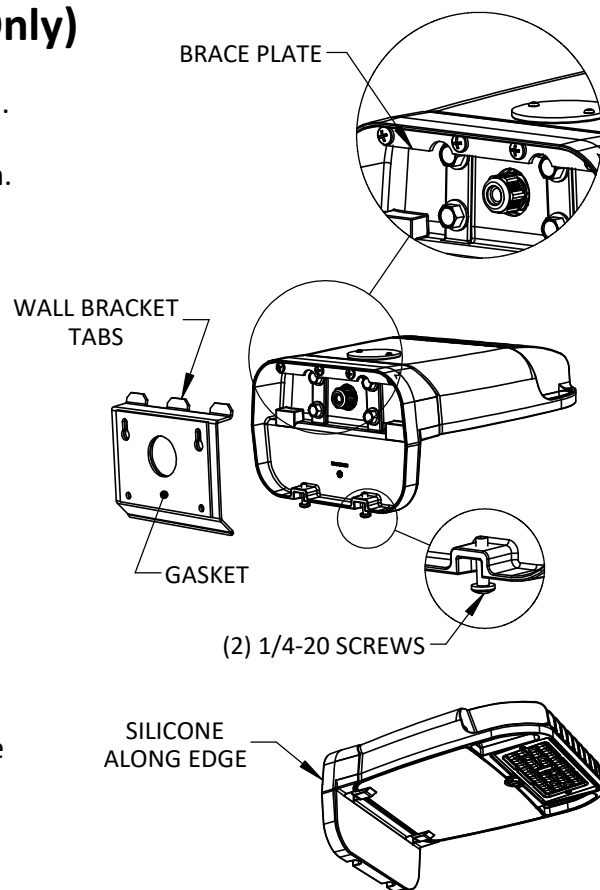

INSTRUCTIONS: SMCB (GL1, GL2, GL3 Only)

- Use or reference template to mark and drill for (4) 1/4" hardware suited for mounting surface. Ensure template is level.
- Optional: Drill slip holes for octagon box mounting.
- Secure SMCB to wall with hardware (not supplied) and use the conduit entry locations to feed supply wires through.
- Remove (4) 1/4-20 screws from SMCB assembly and use them to attach the fixture's wall bracket.
- - Tabs on bracket must be on top as shown.
- - Face gasket on wall bracket towards SMCB.
- - Torque screws to 75-78 in-lbs.
- Feed fixture wires through center opening in wall bracket.
- Position supply wires and fixture wires behind the bracket but to the left or right of it for easy access.
- Mount fixture to SMCB in same manner as Wall Pack instructions above.
- Use wire nuts (not supplied) to connect fixture wires to supply wires and tuck inside SMCB.
- - Connect SMCB's ground wire to supply wire and to the fixture's ground wire.
- Fasten fixture to wall plate on the SMCB with (2) 1/4-20 screws and torque to 15 in-lbs.
- Apply RTV or silicone to seal along top and side edges of the SMCB and the wall pack housing. Do NOT seal along bottom edges.
- Turn on power.

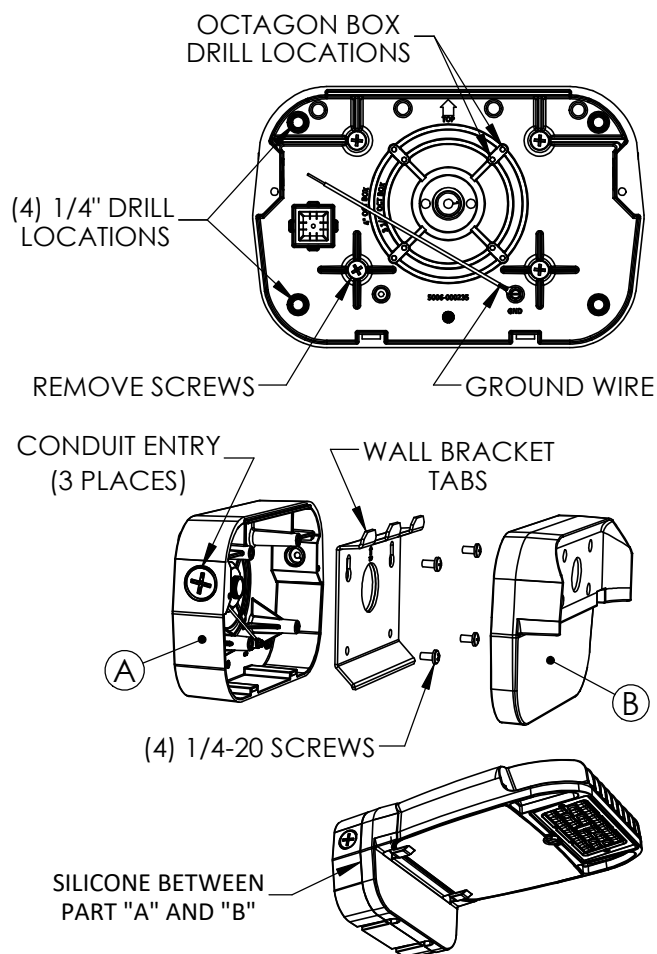

5017-000014, rev. A

- **CONFIRM PRINT IS FULL SCALE PRIOR TO USE.**
- **TOP HOLE - 2" MINIMUM FROM TOP OF POLE. CONFIRM FIT WITH POLE CAP.**

**SHORT SITE ARM (SA)
& FIXED ARM (FA)**

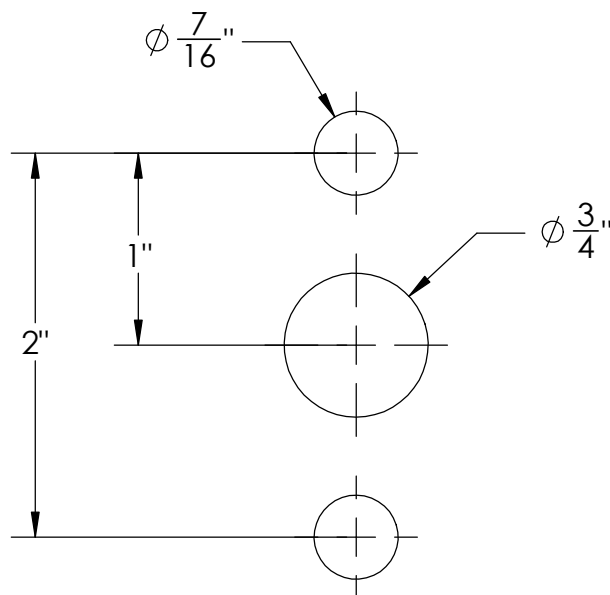

- **CONFIRM PRINT IS FULL SCALE PRIOR TO USE.**
- **TOP HOLE - 2" MINIMUM FROM TOP OF POLE. CONFIRM FIT WITH POLE CAP.**

EXTENDED SITE ARM (ES)

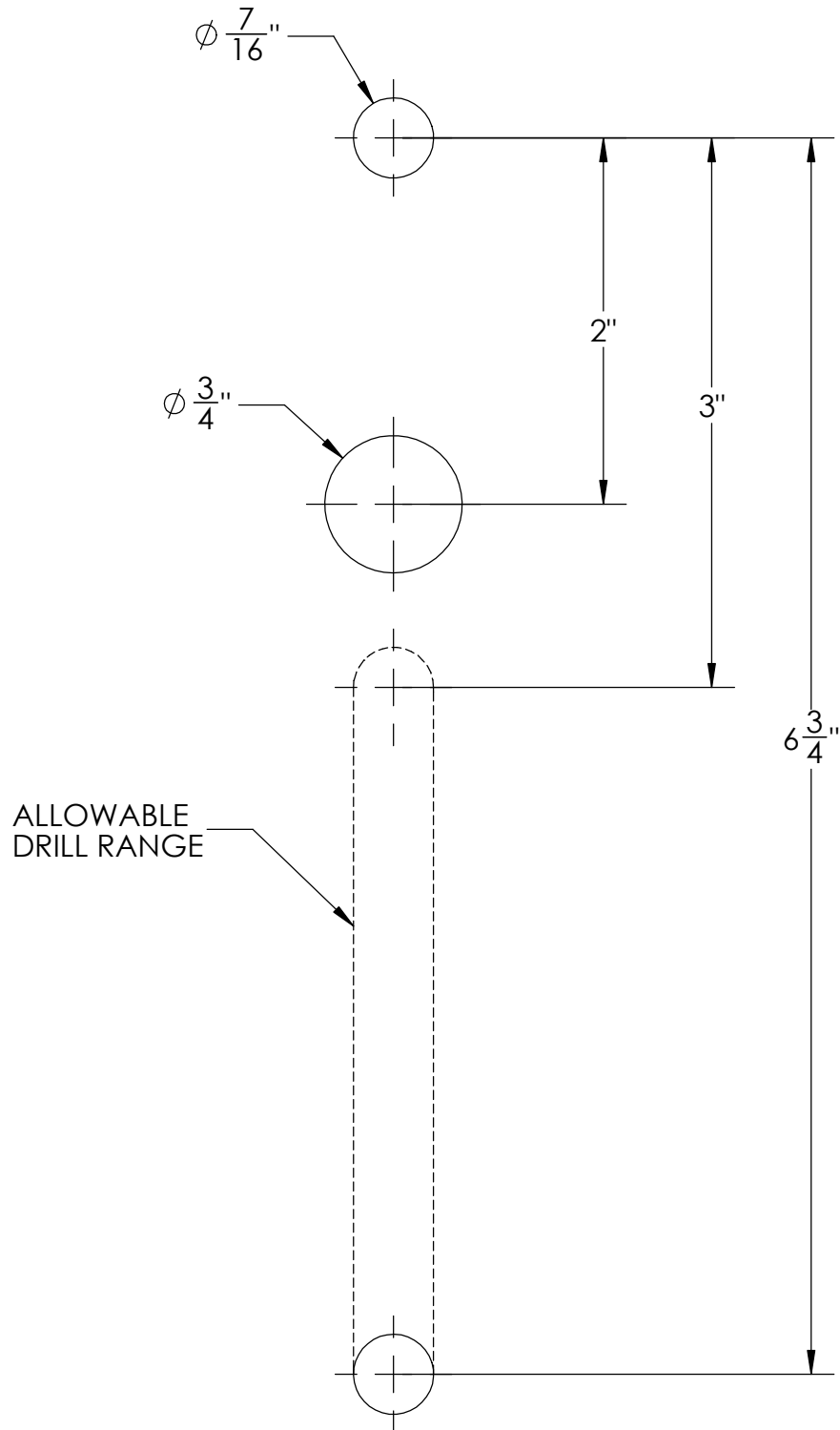

5017-000005, rev. E

- **CONFIRM PRINT IS FULL SCALE PRIOR TO USE.**
- **MARK AND DRILL FOR 1/4" HARDWARE APPROPRIATELY SUITED FOR MOUNTING SURFACE.**
- **CONSULT FACTORY OR CONFIRM WITH ACTUAL PARTS IF WALL PACK IS OLD OR NEW.**

WALL PACK (WP) 5025-000171 - OLD

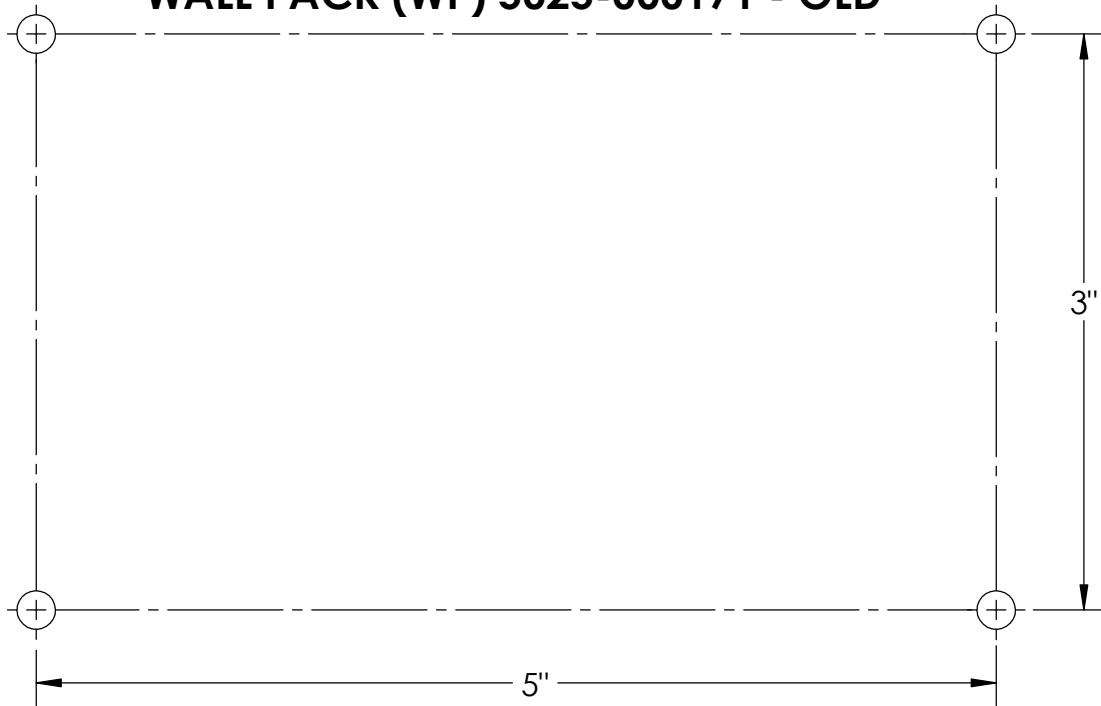

WALL PACK (WP) 5025-000534- NEW

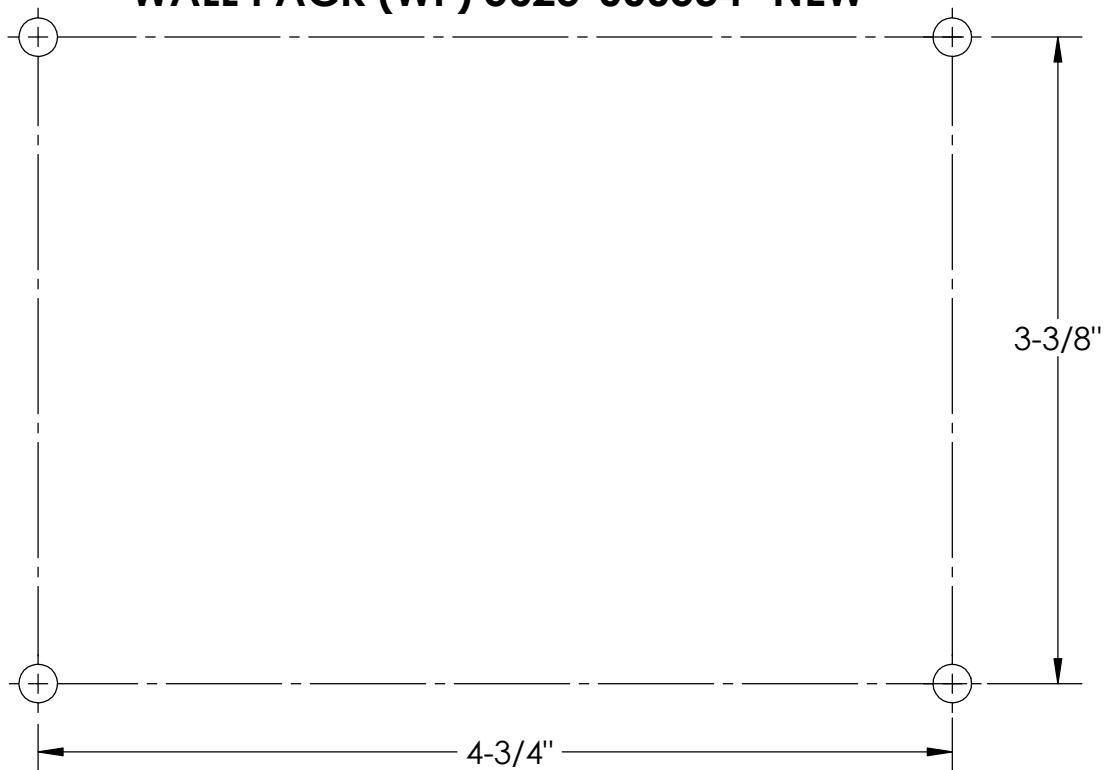

5017-000005, rev. E

- CONFIRM PRINT IS FULL SCALE PRIOR TO USE.
- MARK AND DRILL FOR 1/4" HARDWARE APPROPRIATELY SUITED FOR MOUNTING SURFACE.

SURFACE MOUNT CONDUIT BOX (SMCB)

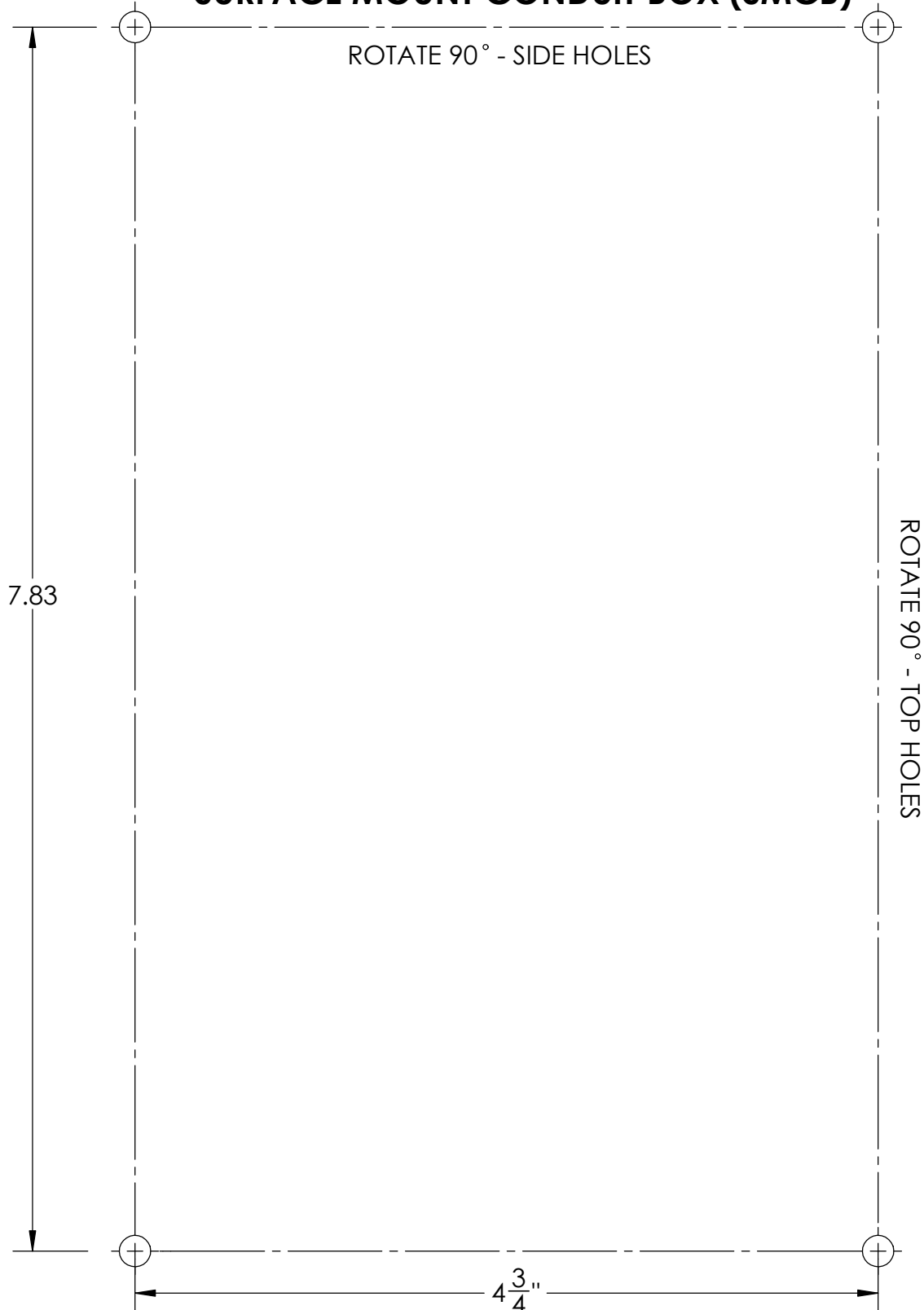

5017-000005, rev. E

Receptacle

INSTALLATION INSTRUCTIONS

ENERGYLITE



IMPORTANT: Read ALL instructions before starting installations.







CAUTION: To reduce risk of shock, **TURN OFF ELECTRICAL SUPPLY** before installing/servicing fixtures.

WARNING: Fixture must be installed in accordance of National Electrical Code (NEC) and /or any local codes.
Failure to do so may result in serious injury and/or damage to the fixture.

SAFETY INSTRUCTIONS

- **Verify that supply voltage matches the voltage marked on the fixture label. Failure to do so may result in damage to the light fixture and will void the warranty.**
- Observe and follow all label information and instructions regarding dry, damp and wet location listings, proper type and wattage, warnings of installation near combustible materials and or insulation.
- Be sure to connect ground wire to prevent electric shock or other potential hazards.
- Product must be installed in a manner consistent with the intended use and in compliance with national electrical codes and local codes.
- This product must be installed in accordance with the applicable installation code by a person familiar with the construction and operation of the product and the hazards involved.
- These instructions do not purport to cover all details or variations of installations, operation or maintenance. Contact Solais Lighting Group if a specific problem or clarification needs to be addressed that is not covered by these instructions.

RECOMMENDED TOOLS

Wire Nuts	Wire Cutter/Stripper	Hardware	Drill and Paper Hole Diagram	Torx T-15 and #2 Phillips	$\frac{7}{16}$ " and $\frac{9}{16}$ " Ratchet/Socket & torque wrench
		<ul style="list-style-type: none">• $\frac{1}{4}$ - 20 hardware• #8 - 32 x $\frac{1}{2}$" screws• $\frac{3}{8}$ - 16 x 2" bolts 			

WIRING DIAGRAM

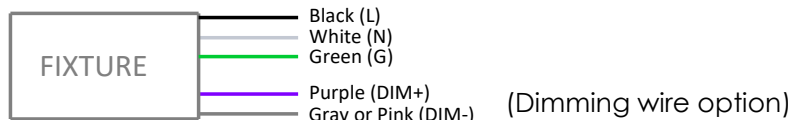

INSTRUCTIONS:

- **Photocontrol Receptacle Adjustment**
 - Loosen (2) 6-32 screws on receptacle cover.
 - Rotate center of receptacle with screw driver so that the arrow points in the north direction.
 - Refasten receptacle cover with (2) 6-32 flathead screws to 5-6 in-lbs.
 - Install photocell or shorting cap (not supplied).

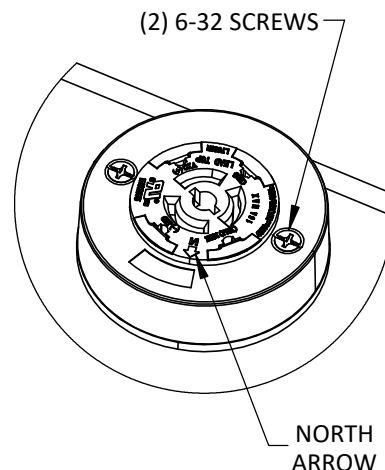

5017-000013 Rev B